

QCCP NAME	DESCRIPTION	DATE
▲		
▲		
▲		

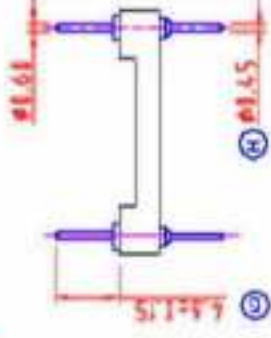

P.C.B. LAYOUT

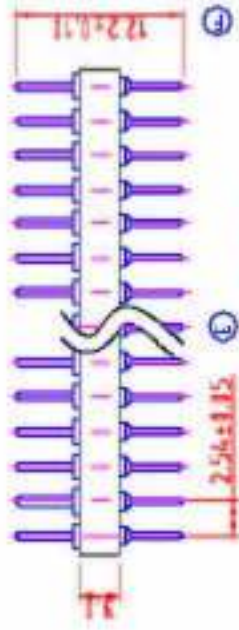
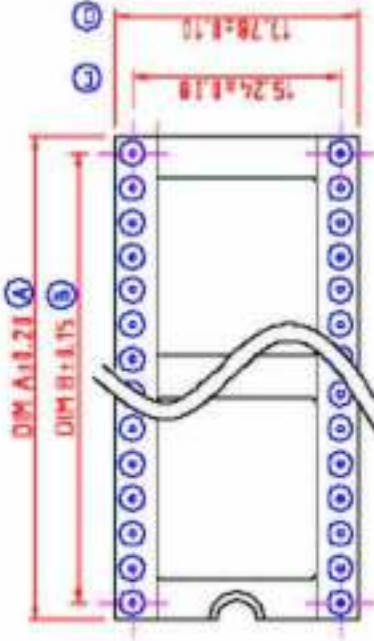
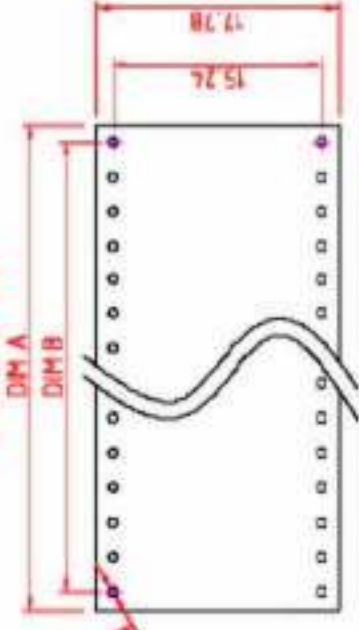

- Technical Data:
- Material:
- Pin Insert: Stainless - Brass, machined, CuZn38Pb2
 - Pin Insert/Outer sleeve: Tin plated 2um/80u" nickel, 3um/211u" Tin
 - Pin Insert/Outer sleeve: Gold plated 2um/80u" nickel/Full gold
- Insulator body/housing: Polyimide/Brass (Insulator, 94V-0)
- Electrical:
- Current rating: 3 Amps/contact max.
 - Insulation resistance: >1000MΩ at V_I=10V
 - Operating: 61 Volt
- Mechanical:
- Operating temperature: Gold plated: -55°C to +125°C
 - Insulation: Tin plated: -40°C to +135°C
 - Soldering temperature: +260°C, 10s max.

Contact	DIM A	DIM B	Contact	DIM A	DIM B
24	30.48	77.94	47	53.34	50.80
28	35.56	33.07	48	60.96	50.42
32	40.64	36.10	50	63.50	60.96
36	45.72	43.18	52	66.04	63.50
40	50.80	48.26			

PART. NAME: TB-Excludes To 2 Pin/3 Pin/4 Pin/5 Pin/6 Pin/7 Pin/8 Pin Series

APPROVAL	DESIGNED BY	CHECKED BY	DATE	REVISION NO.	REVISION BY
		黃新強	2003.11.22	1	
		吳文輝	2003.10.29		

Tolerance	A	B	C	D	E	F	G
±0.13							
±0.10							
±0.08							
±0.05							