

	A	B		A	B
1		2.54	21	50.80	53.34
2	2.54	5.08	22	53.34	55.88
3	5.08	7.62	23	55.88	58.42
4	7.62	10.16	24	58.42	61.96
5	10.16	12.70	25	61.96	63.50
6	12.70	15.24	26	63.50	66.04
7	15.24	17.78	27	66.04	68.58
8	17.78	20.32	28	68.58	71.12
9	20.32	22.86	29	71.12	72.56
10	22.86	25.40	30	73.66	76.20
11	25.40	27.94	31	76.20	78.74
12	27.94	30.48	32	78.74	81.26
13	30.48	33.02	33	81.26	83.82
14	33.02	35.56	34	83.82	86.36
15	35.56	38.10	35	86.36	88.90
16	38.10	40.64	36	88.90	91.44
17	40.64	43.18	37	91.44	93.98
18	43.18	45.72	38	93.98	96.52
19	45.72	48.26	39	96.52	99.06
20	48.26	50.80	40	99.06	101.60

SPECIFICATIONS
 CURRENT RATING:1 Amp
 INSULATOR RESISTANCE:5000 MEGOHMS MIN 500V DC FOR 1MINUTES
 CONTACT RESISTANCE:20M OHM MAX.
 DIELECTRIC WITHSTANDING:AC 500V FOR 1 MINUTES.
 OPERATING TEMPERATURE:-25°C~85°C
 CONTACT MATERIAL:PHOSPHOR BRONZE
 CLIP:BERYLLIUM COPPER
 INSUALTOR MATERIAL:NYLON.UL 94V-0 © STANDARD :NYLON-66
 CONTACT MARTHIAL:PHOSPHOR BRONZE

PROJ		SCALE : F DO NOT SCALE DWG	MOLD NO 2150		
APP		93.04.04	MODEL	FILE NO	REV.
CHK	CCJ	90.06.26	ROUND PIN	PIN HEADER	X1
DGN	AMY	90.06.26	UNIT	SHT 1 OF 1	SIZE
DRW	SHIEH	90.06.26	MM		A4

雷騰/PPS 物性表

	ASTM	單位	R-3	R-4	R-5	R-7	R-10 7006A(NAT)	R-10 5022C(BLACK)	R-10 5804A(BLACK)	A-100
比 重	D-792	—	1.57	1.67	1.72	1.9	2.0	2.0	2.0	1.65
吸水率(23℃/水中/24hrs)	D-570	%	0.05	0.05	0.05	0.03	0.07	0.07	0.07	—
成形的縮率(1mm 沿軸方向)	D-355	mm/cm	0.0005	0.0025	0.0030	0.0015	0.0015	0.0015	0.0015	—
抗 拉 強 度	D-638	kg/cm ²	1120	1230	1330	980	950	770	700	1250
伸 長 率	D-638	%	1.0	0.9	0.8	0.7	0.7	0.7	0.7	1.6
抗 折 強 度	D-790	kg/cm ²	1370	1820	1960	1610	1400	1260	1120	1750
抗 折 模 數	D-790	kg/cm ²	9.8×10 ⁴	11.9×10 ⁴	14.7×10 ⁴	16.8×10 ⁴	14.0×10 ⁴	14.0×10 ⁴	14.0×10 ⁴	12×10 ⁴
抗 壓 強 度	D-695	kg/cm ²	1610	1820	1820	1610	1300	1300	1230	1610
艾臣德(IZOD)衝擊強度	D-256	kg-cm/cm								
3.2mm 有 缺 (NOTCHED)			5.4	7.1	7.1	5.4	5.4	4.4	3.8	6.5
3.2mm 無 缺 (UNNOTCHED)			18	25	27	19	15	12	9	33
洛氏 (ROCKWELL) 硬 度	D-785	R-SCALE	120	123	123	121	120	120	120	116
熱變形溫度(18.6kg)※	D-548	℃	260	260	260	260	260	260	260	260
UL 溫 度 指 數	UL	℃	200/220	200/220	200/220	200/220	200/240	200/240	200/240	200/220
線 熱 膨 脹 係 數	D-696	×10 ⁻³ cm/cm/℃	3.1	2.9	2.7	2.0	2.2	2.2	2.2	—
導 熱 係 數	—	W/m℃	—	0.23	—	0.6	0.46	0.46	0.46	—
氧 氣 指 數			46	47	48	53	53	53	53	—
燃 燒 性	UL-94		94 V-0	94 V-0 94 5-V	94 V-0	94 V-0	94 V-0	94 V-0 94 5-V	94 V-0 94 5-V	94 V-0
絕 緣 耐 壓 電 壓	D-149	kV/mm	17.2	17.2	17.2	13.0	15.8	12.6	12.8	—
介 電 常 數	D-150	IKHz/IMHz	3.9/3.8	3.9/3.8	4.0/3.9	5.1/4.6	—	—	4.7/4.5	—
介 電 散 逸 (正 切)	D-150	IKHz/IMHz	0.002/0.0014	0.002/0.0014	0.002/0.0014	0.003/0.0028	—	—	0.008/0.007	—
體 積 固 有 電 阻	D-257	Ω · cm	1×10 ¹⁶	1×10 ¹⁶	1×10 ¹⁶	5×10 ¹⁵	—	—	5×10 ¹⁵	—
耐 電 弧	D-495	Sec.	10	34	128	167	116	116	182	—
電弧跟踪(Arc TRACKING RATE)		cm/min.	4.5	2.8	2.5	0	0	0	0.6	—
CTI 踪 跡 (TRACKING)		V	130	300	130	225	220	160	240	—

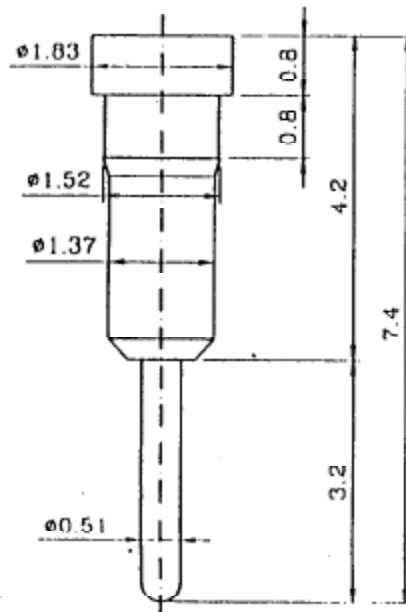

ELECTRICAL
 CURRENT RATING: 3 AMP/CONTACT MAX.
 CONTACT RESISTANCE: $\leq 4M \Omega$ /CONTACT
 RESISTANCE: $\geq 10^3 M \Omega$ AT $V=100V$
 INSULATION RESISTANCE: $\geq 10^3 M \Omega$ AT $V=100V$
 OPERATING VOLTAGE: 80VAC/DC
MECHANICAL
 AVERAGE INSERTION FORCE WITH STEEL PIN $\leq 3N$
 $\phi 0.41MM/.016"$
 AVERAGE WITHDRAWAL FORCE WITH STEEL PIN $> 0.4N$
 $\phi 0.41MM/.016"$
 MECHANICAL LIFE: MIN 200 CYCLE
 OPERATING TEMPERATURES: GOLD PLATED
 -55°C TO +125°C
 (CONTINUOUS) -67°F TO +257°F
 TIN PLATED:
 -40°C TO +105°C
 -40°F TO 221°F
 SOLDERING TEMPERATURE: +280°C, 10S MAX.
 +500°F, 10S MAX.

TECHNICAL DATA
MATERIAL
 PIN: BRASS, MACHINED
 (OUTER SLEEVE) CuZn38Pb2
 CLIP: BERYLLIUM COPPER, (CONTACT) HEAT TREATED (4 FINGER)
 PLATING PIN: TIN PLATED;
 (OUTER SLEEVE) 2um/80u" NICKEL
 5um/200u" TIN
 GOLD PLATED;
 2um/80u" NICKEL
 0.25um/10u" FULL GOLD
 PLATING CLIP: 2um/80u" NICKEL
 (CONTACT) GOLD (5u") AND TIN PLATING
 SEE TABLE BELOW
 INSULATOR: GLASS FILLED POLYESTER
 BODY: VALOX UL 94 V-0 (BLACK)

FILE	2227MC-6604S-6603								GENERAL TOLERANCE:
DATE	03-30-1998			50~180	0.2	0.3	0.8	1.2	± 0.2
				18~50	0.1	0.15	0.4	0.6	UNIT:MM
				6~18	0.00	0.1	0.3	0.4	SCALE: SHEET:10F1
				0~6	0.05	0.08	0.2	0.3	DRAWN: JERRY CHEN
REV	DESCRIPTION	ZONE	NAME	GRADE	A	B	C	D	CHECKED: PETER HUANG
⊕ ADD	⊖ REMOVE	⊗ WAS		TOLERANCE	(±)				UNIT:MM

DESCRIPTION: ROUND PIN 4/6 FINGER DATA SHEET

PART NO:

SIZE

A4

April 8, 1992

(PPS)

TONEN CHEMICAL CORP NEW PRODUCTS DIV

E125354 (M)
(B-cont. from A card)

Polyphenylene sulfide (PPS) furnished in the form of pellets.

GT(a)(b)(c)	All	0.80	94V-0	105	105	105	—	—	—	—	—
HT(a)(b)(c)	All	0.80	94V-0	105	105	105	—	—	—	—	—
GB(a)(b)(c)	All	0.80	94V-0	105	105	105	—	—	—	—	—
HB(a)(b)(c)	All	0.80	94V-0	105	105	105	—	—	—	—	—
GK(a)(b)(c)	All	0.80	94V-0	105	105	105	—	—	—	—	—
HK(a)(b)(c)	All	0.80	94V-0	105	105	105	—	—	—	—	—

(a) A one digit number (1-9) denoting melting viscosity.

(b) A two digit number (20-70) denoting inorganic fillers in weight by percent.

(c) A one or two digit optional number (1-50) denoting color code.

Reports: March 10, 1992; March 10, 1992; March 10, 1992; March 10, 1992; March 10, 1992; March 10, 1992.

470151001

N7047

Underwriters Laboratories Inc.®

(Cont. on C card)

011/0182115