

C0562-XXMBAXXR

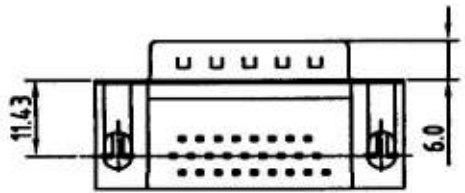

ELECTRICAL CHARACTERISTICS

Contact Current Rating:3Ampères.
 Dielectric Withstanding Voltage:AC 500V at sea level.
 Insulation Resistance:1000Megohms Min.
 Contact Resistance:25Milliohms Max.
 Operation Temperature : -55°C to +105°C.

Material

Contact :Copper Alloy.
 Insulator:PBT. [Select PA6T /LCP /PA9T]
 Shell: SPCC.
 Z-Piece: Copper Alloy.
 Screw: Copper Alloy.
 Rivet: Copper Alloy or Zinc.

Note:

No.	A	B	C	E	F	H
15	16.92	24.99	30.81	2.29	1.145	7.04
26	25.25	33.32	39.14	2.29	1.145	6.88
44	38.96	47.04	53.04	2.29	1.145	6.88
62	55.42	63.50	69.32	2.41	1.205	7.00

S:C0562-XXMACXXXR S:C0562-XXMBCXXXR S:C0562-XXMBBXXXR
 L:C0562-XXMAEXXXR L:C0562-XXMBEXXXR L:C0562-XXMBDXXXR

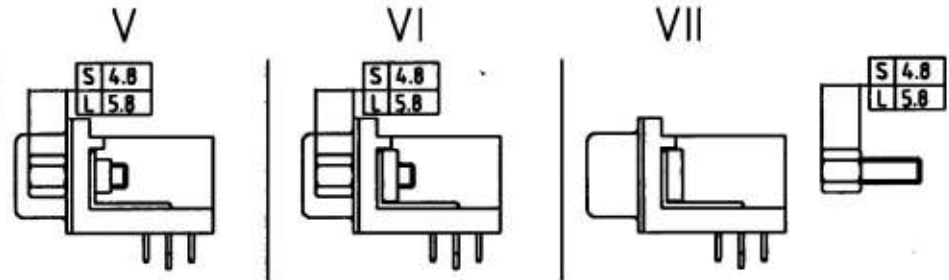

Re Layout P.C.B.
15 POSITION

Re Layout P.C.B.
26 /44 /62POSITION

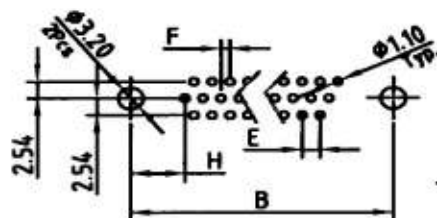
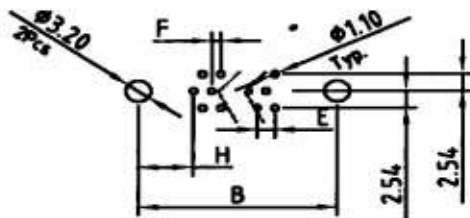

**RoHS
Compliant**

C0562-15MACASBR

APPD. 标准	SCALE 比例	TOLERANCE 容差公差	PART NAME 品名 HIGH DENSITY D-SUB PCB RIGHT ANGLE STAMPED XXP MALE TYPE ROSH LOW-LEAD PART NO. 料號
DWG. 製圖	UNIT 單位	SIZE. 觸線尺寸	
DATE 制表日	PAGE 張數	REV. 版次	
2008/8/12	1 OF 1	A	
HELEN	MM	A 4	C0562-XXMXXXXXR