

SPECIFICATIONS

Voltage rating:300V AC,DC

Current rating:12A AC,DC

Withstanding voltage:1500V AC/minute

Insulation resistance:1000M OHM min

Temperature range:-25°C~+90°C

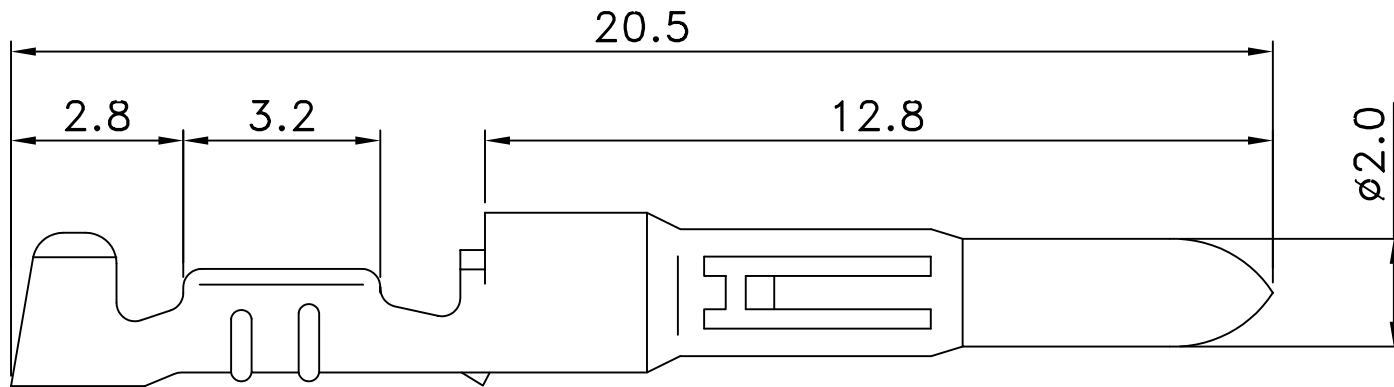

Part NO	WIRE RANGE	O.D.OF WIRE INSULATION	MATERIAL	PLATING	QUANTITY PER REEL
	AWG				
L-M-14	20-14	1.9-3.4	PHOSPHOR BRONZE	TIN-PLATED	3500
L-M-20	24-20	1.5-2.7	PHOSPHOR BRONZE	TIN-PLATED	5000

RoHS Compliant

TOLERANCES ARE

DRAWING BY CY		X, ±
CHECKED BY GENIUS		.X ±
UNIT / mm	SCALE 1 : 1	.XX ±
DATE		.XXX ±
SIZE A4	PPOJECTION	ANG ±



ORDER INFORMATION

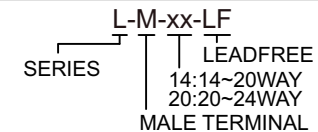

DESCRIPTION:

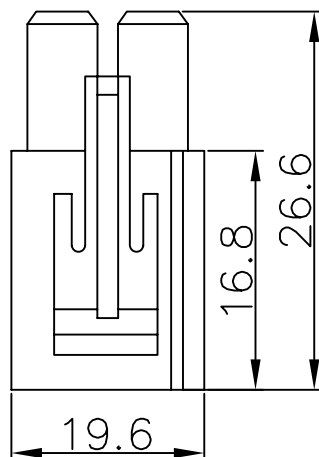
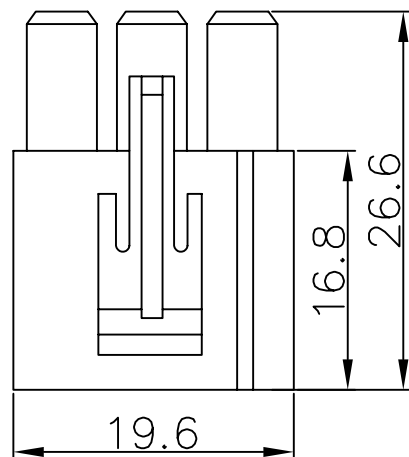
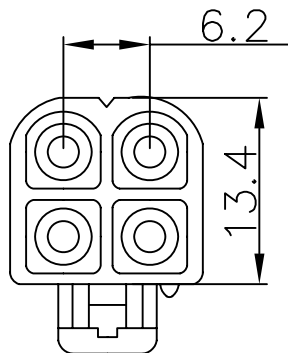
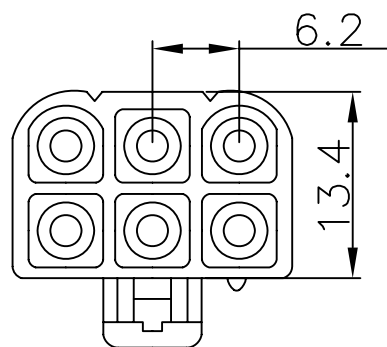

L-S-2X03

L-S-2X02

SPECIFICATIONS

Circuit:1,2,3,4,6,9,12,15

Voltage rating:300V AC,DC

Current rating:12A AC,DC

Withstanding voltage:1500V AC/minute

Insulation resistance:1000M ΩHM min

Temperature range:-25 C~+90 C

Material:UL94V-2 nylon 66

RoHS Compliant

TOLERANCES ARE

DRAWING BY CY	
CHECKED BY GENIUS	
UNIT / mm	SCALE 1 : 1
DATE	
SIZE A4	PPOJECTION

X. ±
 .X ±
 .XX ±
 .XXX ±
 ANG ±



ORDER INFORMATION

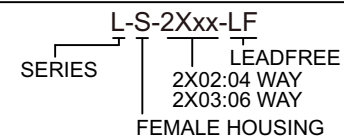

DESCRIPTION: